

Askoll

PURE^S AQUARIUM KIT

Instruction manual

Manuale di istruzioni

Manuel d'instructions

Bedienungsanleitung

Handleiding

руководство по эксплуатации

EASY**AQUARIUM**



Congratulations!

By purchasing an Askoll PURE S Aquarium you will not only enjoy a fully made-in-Italy design that harmonises well with several interior design styles, but you will also be able to rely on a product that concentrates the best of Askoll technology, a company that can boast more than thirty years experience in the design and production of articles for aquariums and ponds.

In just a few minutes, after starting installation, we are sure that you will appreciate a product conceived in every detail to make any operation easy and fast. You will enjoy even more the moment in which you will be able to dedicate your time to create a nature corner in your new Askoll PURE S Aquarium and you will be able to count on cutting edge devices to preserve the beauty of the aquatic world along the time, in a simple way.

Before starting, kindly read and follow the warnings and hints contained in this manual carefully.

To choose fish, plants, and the arrangement suitable for your aquarium, follow the suggestions of an expert retailer.

1. IMPORTANT SAFETY INFORMATION

This product was designed and manufactured in compliance with the 2006/95/EC and 2004/108/EC Directives to assure a safe use along its entire life-cycle. However, an improper use of the product (not complying with the provisions of this manual) may cause damages to the product and jeopardise the user's safety.

WARNING



Before using the product read and understand this instruction manual in all its parts.

This manual is an integral part of the product: keep it for future reference.



This product is not intended for use by persons (including children) with reduced physical, sensory and mental capabilities or lack of experience and knowledge, unless they have been given supervision or instruction concerning the use of the product by a person responsible for their safety. Children should be supervised to ensure that they do not play with the product.

To avoid electric risk:



Each power cable of the electric devices has to show a drip loop positioned lower than the plug-outlet connection point in order to prevent any drop from reaching such point.



The electric devices plug and outlet should not get wet.



Should the plug or outlet of any of the electric devices become wet, do not disconnect the cable. Disconnect power supply to the electric system acting on the main switch.



Disconnect the plugs of the electric devices from the outlets before handling the product and/or immersing the hands in water.



Never pull the cable of the electric devices to disconnect the plugs from the outlets. To disconnect them, grab the plugs and pull them.

WARNING

To avoid instability risk: check with a level that the support surface of the product is horizontal.
Do not lean the product on inclined surfaces.

After installation, do not move the product.
If necessary, move it only if the tank is completely empty.

Do not connect the electric devices of the product to the mains before having completed the installation or having repositioned the same after maintenance operations. Do not use the pump dry.

To avoid the risk of burns:
After disconnecting the plug, let the hot parts of the lighting unit cool down (about 5 minutes) before handling them.

Do not direct the light beam produced by the lighting unit directly in the eyes of people.

Check that the water is always at the level shown on the frame.

After maintenance operations, if necessary, restore the proper water level.

CAUTION

Use the product exclusively as decorative aquarium for indoor domestic use.

Each component is an integral part of the product.
It shall not be used on other products.

Do not use the product for use with foodstuffs.

Do not use the product as terrarium.

Do not use the product, if damaged and/or disassembled.

Do not lean any rocks, stones or other heavy decorating elements directly on the bottom of the tank.

Do not place any item on the product.

Verify the integrity of the product before pouring water into the tank.

Install the electric devices of the product observing the voltage and frequency values shown on the devices and the temperature ones specified among the technical data under **par. 3.4.**

Connect the electric devices to mains protected by a residual current device with a sensitivity ≤ 30 mA.

CAUTION

After maintenance operations, if necessary, dry the external parts of the product and the surface on which it is positioned.

To protect the polished surfaces of the product from scratches and scrapes, pay utmost care when cleaning and handling the same.

Do not cut the power cables.
Power cables cannot be repaired.
If the cable is damaged, the product has to be discarded.

Do not use extension cables.
If the length of the power cable of the electric devices is not sufficient, refer to an electrician.

Do not try to repair any product component: in case of damage replace the damaged component with original spare parts **(see chap. 9)**.

2. TABLE OF CONTENTS

1. IMPORTANT SAFETY INFORMATION.....

2. TABLE OF CONTENTS.....

3. PRODUCT SPECIFICATIONS.....

4. PREPARE PRODUCT FOR USE

5. OPERATION INSTRUCTIONS.....

6. MAINTENANCE AND CLEANING.....

7. TROUBLESHOOTING.....

8. STORAGE AND PACKAGE

9. SPARE PARTS.....

10. PRODUCT DECOMMISSIONING

1

3

3

6

8

9

12

12

12

12

3. PRODUCT SPECIFICATIONS

3.1. Product identification

Name	Askoll PURE Aquarium KIT		
	Model	PURE S	
Components	Model	LIGHT UNIT S	
	Version	AC 230 V	AC 240 V
	Type	D-52020	D-52021
Lighting unit	Model	PURE PUMP 170	
	Type	C-19011	
Pump	Model	PURE PUMP 170	
	Type	C-19011	

3.2. Component name and package content

Check that the package contains the components shown in the following figures.

1 Product and frame detail

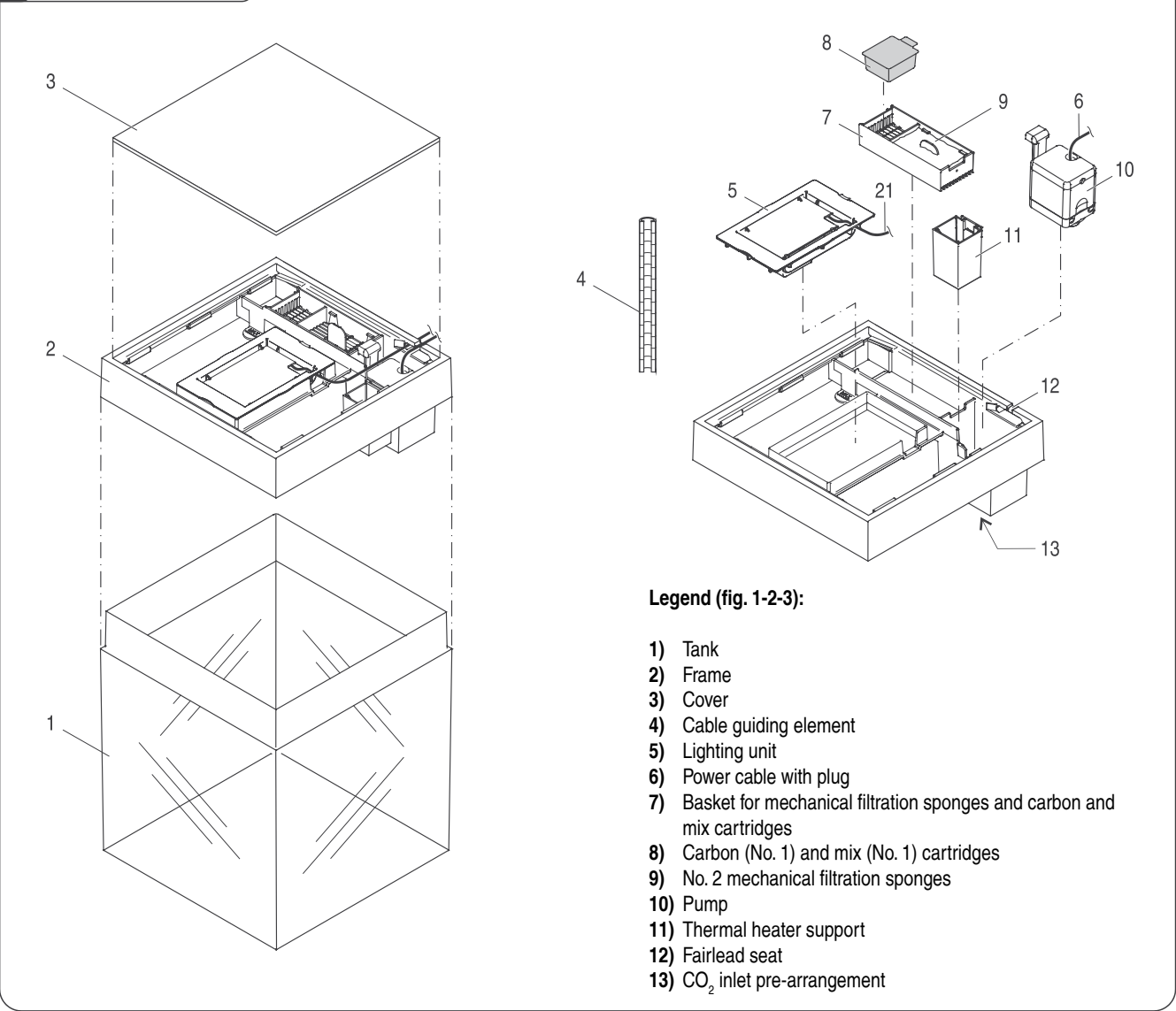

2 Detail: Pump

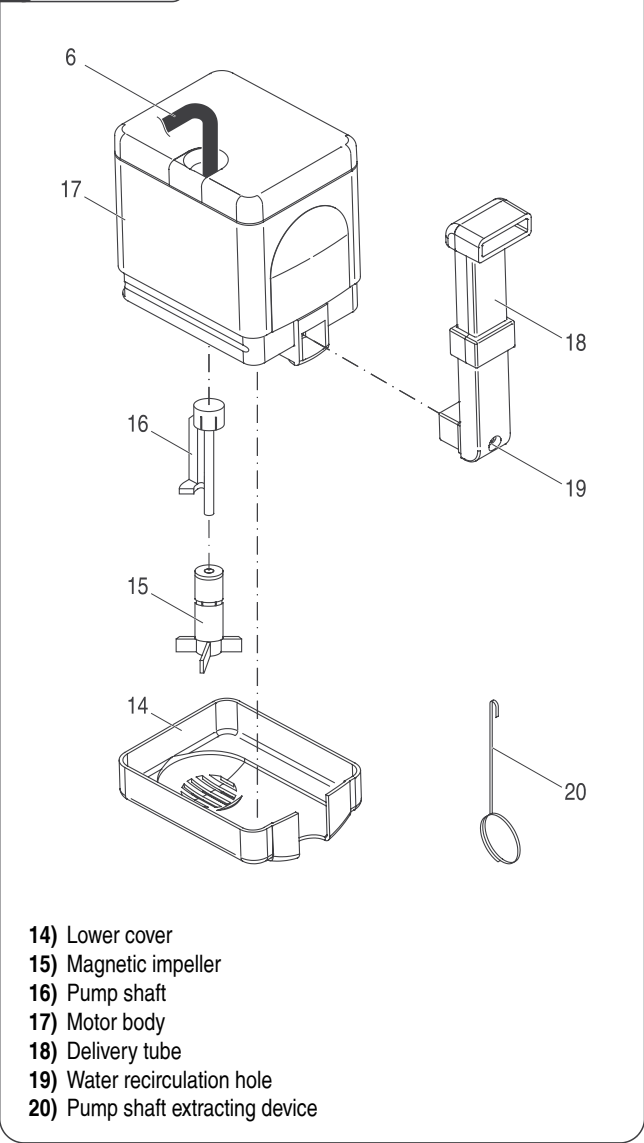

3 Detail: Lighting unit

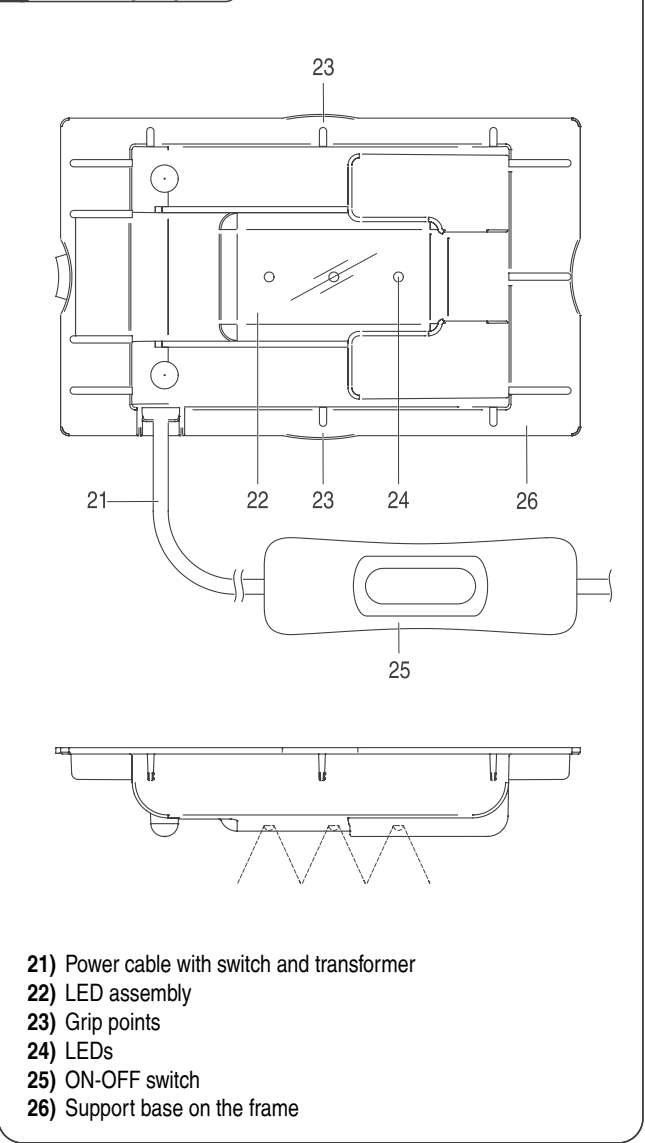

3.3. Optional modules

The product may be equipped with the following modules (not included).

Module	Function
Askoll CO ₂ System - CO ₂ PRO-GREEN SYSTEM	It allows providing CO ₂ to the aquarium thus easing plant growth.
Askoll THERM S thermal heater (35W)	It allows regulating aquarium temperature (from 18°C to 31°C).

3.4. Technical data

Description		
Capacity	/	13
	Imp gal	2.85
Product weight	kg	2.92
Max. weight with water	kg	18
Height	cm	29
Width	cm	24.5
Depth	cm	24.5
Water temperature (min./ max.)	°C	from +5 to +35
PUMP / LIGHTING UNIT		
Power supply	V / Hz	See data given on the individual electric devices making up the product.
Consumption	W	
IP protection code		

4. PREPARE PRODUCT FOR USE

4.1. Unpacking

- 1) Open the package, remove the corner elements and extract the bag containing the product handling it with care.
- 2) Place it on a flat, smooth and clean surface avoiding to scratch and/or damage the tank bottom.
- 3) Extract from the package the carton containing some disassembled components.
- 4) Dispose of the packaging materials in compliance with the regulations in force in the country where disposal takes place.
- 5) Check that the product has all components shown in **par. 3.2**.

4.2. Positioning

Select the place where to install the product with care, observing the following provisions.

**WARNING**



To avoid instability risk: check with a level that the support surface of the product is horizontal. Do not lean the product on inclined surfaces.

**CAUTION**



Place the product on a sturdy support able to bear the maximum weight set for the product (see technical data). Such support must have a levelled, smooth and clean support surface.



In order not to ease algae proliferation, place the product far from heat sources and direct exposure to sunlight.

Place the product with the fairlead seat on the rear side and at such a distance from the outlet that it is possible to create a drip loop for each of the power cables of the electric devices.

4.3. Installation

**WARNING**



Do not connect the electric devices of the product to the mains before having completed the installation or having repositioned the same after maintenance operations. Do not use the pump dry.



After installation, do not move the product. If necessary, move it only if the tank is completely empty.

**CAUTION**



To clean the product do not use abrasive products, toxic substances or detergents.

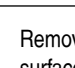

Also prevent algae or other items present in the tank from clogging the hole for water circulation or the pump inlet grids.

- 1) Remove the frame and the cover (place them on a flat and clean surface, avoid scratching them)
- 2) Rinse the inner side of the tank under running water (**see fig. 4**).
- 3) Prepare the tank bottom (sand or other suitable material) according to the arrangement desired.
- 4) Slowly fill the tank with about 1/3 water and place any decorations or aquatic plants.
- 5) Place the frame back on the tank and slowly fill the tank until water

reaches the level shown on the frame (**see fig. 5**).

- 6) Close the cover and verify that there are no leaks.

4.4. Assembly

- 1) Remove the cover and extract the basket for the mechanical filtration sponges, and the carbon and mix cartridges.
- 2) Extract the mechanical filtration sponges, rinse them under running water and place them back into the basket (**see fig. 6**).
- 3) Open the bag containing the carbon cartridge, rinse it under running water and place it back in the basket (**see fig. 7**) (it will be replaced by the mix cartridge according to the instructions given under **chap. 6**).
- 4) Place the basket with the mechanical filtration sponges and the carbon cartridge in the frame.
- 5) Set the pump flow rate selector (**see fig. 8**) to the maximum value and insert the pump into the frame.
- 6) Insert the lighting unit into the frame and, if the use of the thermal heater is forecast, insert also the thermal heater support (**see fig. 9**).

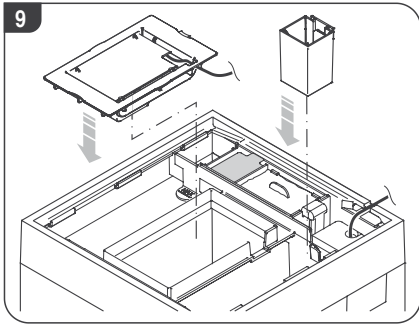
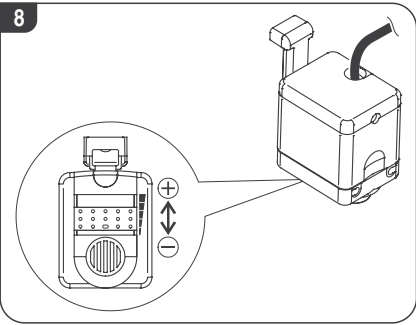
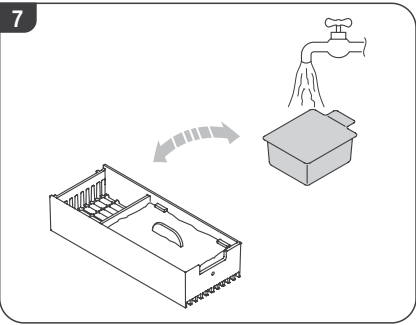
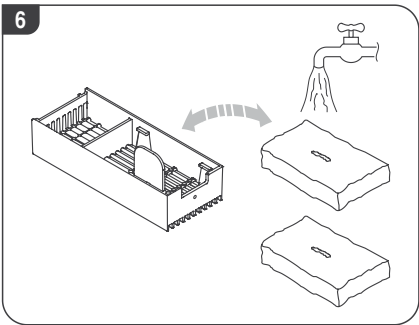
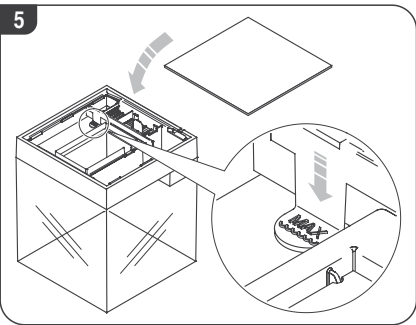
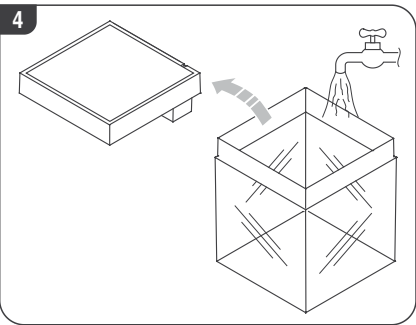

- 7) Lay the power cables (of the lighting unit and pump) into the proper fairlead seat (**see fig. 10**) and then in the cable guiding element (**see fig. 11**).
- 8) Place the cover back and dispose of the carbon cartridge plastic bag in compliance with the regulations in force in the country where disposal takes place.

5. OPERATION INSTRUCTIONS

5.1. Routine operation



WARNING

To avoid electric risk:
Each power cable of the electric devices has to show a drip loop positioned lower than the plug-outlet connection point in order to prevent any drop from reaching such point.

- 1) Read the warnings under **chap. 1**.
- 2) After having connected the plug of each electric device verify the operation of the same (in case of malfunction refer to **chap. 7**):
- Water has to exit from delivery output.
 - By pressing on the ON-OFF switch of the lighting unit, this latter has to start working (press the switch once again to turn it off).
- 3) Add the fish, if wished, according to your own experience and following the rules relating to aquariology good practices.

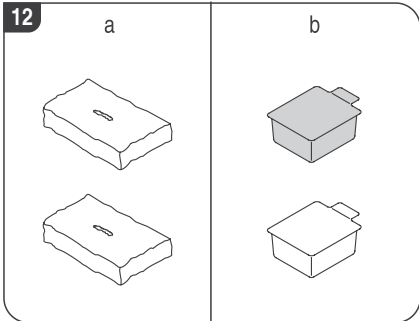
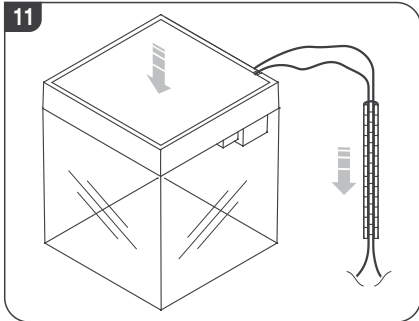
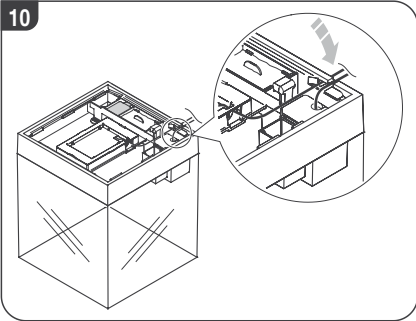

5.1.1. Filtration



CAUTION

Always close the cover, after having performed the necessary operations in order to avoid promoting algae proliferation in the filters due to the presence of light.

In order to provide for the best habitat for fish and plants, the water of each aquarium has to continuously undergo mechanical, biological and chemical filtration.

The **mechanical filtration** (**see fig. 12a**), carried out by the mechanical filtration sponges made of polyurethane, eliminates any suspended particles making water clear. It is always possible to visually check the clogging level of the sponges simply by opening the cover.

The **biological filtration** (**see fig. 12a**), carried out by the nitrifying bacteria nesting in the mechanical filtration sponges, aims at keeping aquarium water free from chemicals, which are harmful for the aquatic fauna, transforming the ammonia produced by the fish into nitrates. In order to allow a sufficient quantity of bacteria to settle down in the filtration media and carry out such water purification function, about 4 weeks are necessary. Therefore, the first month of an aquarium is rather critical and the fish has to be added very gradually in order to allow the nitrifying bacteria to settle down, reproduce and be effective,

Finally, the **chemical filtration** (**see fig. 12b**) is carried out by the active carbon contained in the carbon cartridge or by the mix of resins contained in the mix cartridge. Thanks to the very high carbon porosity, potentially noxious chemical compounds, pharmaceutical residues, smells, waste substances, which reduce water clarity, etc. are removed. The mix cartridge allows removing efficiently nitrates and phosphates, freeing water from the main cause of algae proliferation.

The regular and alternated use of the carbon and mix cartridges

(**see par. 6.2**) allows keeping under control the water pollution degree, efficiently preventing algae development and keeping water clear and crystalline.

REMARK

In saltwater aquariums the mix cartridge function is limited to the removal of phosphates, while it is ineffective against nitrates.

5.1.2. Lighting

Thanks to the high efficiency LEDs, the lighting unit recreates natural lighting and enhances the colours of the aquatic fauna and flora. The lighting unit is controlled by an ON-OFF switch, which allows turning it on and off without need of disconnecting the power plug.

5.1.3. Water recirculation

The pump is equipped with a water circulation hole on the delivery tube to improve water circulation in the aquarium.

5.2. In case of power failure

Power failure (blackout) can result, after some hours, in the progressive deterioration of the biological filter effectiveness with possible following damages to the aquarium ecosystem.

In case of malfunction refer to **chap. 7**.

6. MAINTENANCE AND CLEANING



WARNING

To avoid electric risk:



Disconnect the plugs of the electric devices from the outlets before handling the product and/or immersing the hands in water.



Never pull the cable of the electric devices to disconnect the plugs from the outlets. To disconnect them, grab the plugs and pull them.



Do not connect the electric devices of the product to the mains before having completed the installation or having repositioned the same after maintenance operations. Do not use the pump dry.



To avoid the risk of burns:
After disconnecting the plug, let the hot parts of the lighting unit cool down (about 5 minutes) before handling them.



Check that the water is always at the level shown on the frame.



After maintenance operations, if necessary, restore the proper water level.



CAUTION



Always close the cover, after having performed the necessary operations in order to avoid promoting algae proliferation in the filters due to the presence of light.



In case of saltwater aquariums, perform a frequent and careful cleaning (at least once a month) of the parts affected by saline condensate.

6.1. Maintenance and cleaning interventions

Observe the forecast intervention schedule in order to preserve maximum effectiveness of the product.

Frequency	Intervention point	Intervention description
Every week	Filters	Visual check
	Tank	Water level check
See RFS (see par. 6.2)	Filters	Replacement
Every 6 months	Pump	Cleaning

6.2. Rolling Filtration System

In order to assure maximum efficiency of the filter at any time , as well as the best water conditions in the aquarium, Askoll recommends to replace the filtration media regularly, in compliance with the Rolling Filtration System (RFS). This can be attained very easily by purchasing the original spare parts Kit by Askoll, which includes everything needed.

To replace the sponges and cartridges, proceed as follows:



- 1) Open the cover.
- 2) Remove the sponges and the cartridges and dispose the same in full compliance with the regulations in force in the country where product disposal takes place.
- 3) Replace the sponges and cartridges as established in the table.
- 4) Close the cover.

The PURE FILTER MEDIA KIT S spare parts kit for aquariums Askoll PURE S can be purchased from your trustworthy retailer (see product code under **chap. 9**) and contains the following filtration media:

- 1 sponge for mechanical and biological filtration.
- 1 active carbon cartridge for chemical filtration.
- 1 mix cartridge (anti-nitrates and anti-phosphates) for chemical filtration.

In order to keep optimal aquarium conditions, Askoll suggest purchasing a package of PURE FILTER MEDIA KIT S each month.

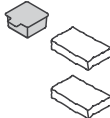
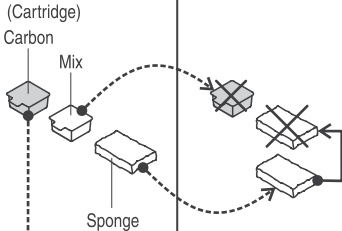
The scheme on the side outlines the replacement sequence for the individual filtration media, which involves the replacement of the sponge for mechanical filtration once every 4 weeks and the alternation of the carbon cartridge with the mix cartridge every 2 weeks.

ROLLING FILTRATION SYSTEM (RFS)				
Period		Spare part	In use	
1 st week	First use			
2 nd week				
3 rd week				
4 th week				
REPLACEMENT CYCLE	5 th week	After 4 weeks from the first use		
	6 th week			
	7 th week	After 6 weeks from the first use		
	8 th week			
	REPEAT THE REPLACEMENT CYCLE EVERY MONTH			
Measure to be taken: ●-----> Replace ✕ Eliminate ●-----> Shift				
NB. The positions of the cartridges and sponges represent the actual arrangement in the aquarium				

6.3. Pump maintenance

6.3.1. Pump cleaning

- 1) After disconnecting the plug of each electric device, remove the cover and extract the cables from the fairlead seat and the cable guiding element (see fig. 13).
- 2) Extract the pump from the frame (see fig. 14).
- 3) Disassemble the delivery tube and the lower cover from the pump (see fig. 15).
- 4) Extract the magnetic impeller and rinse it under running water (see fig. 16).
- 5) Using the proper extracting device, extract the pump shaft and rinse it under running water (see fig. 17).
- 6) Clean the inner side of the pump with a non abrasive bottle brush (see fig. 18).
- 7) Reassemble the disassembled components and place the pump and the cover back to their position, repeating the above described procedure in opposite order.

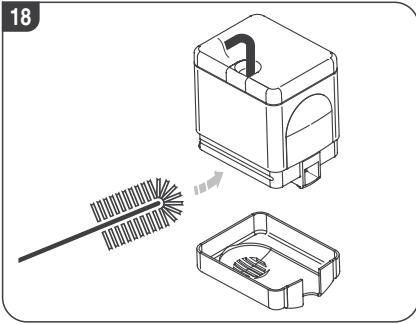
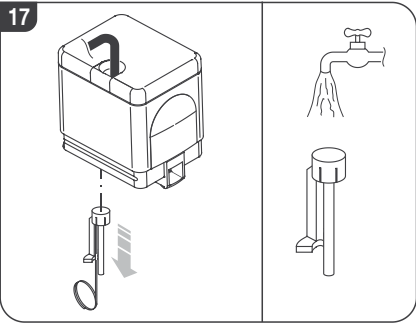
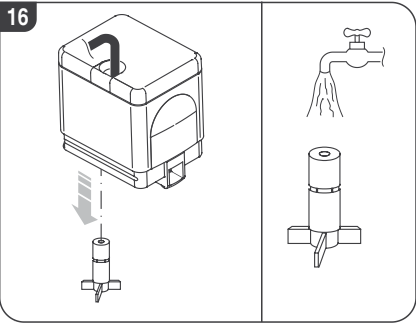
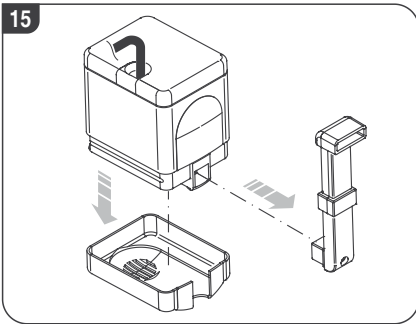
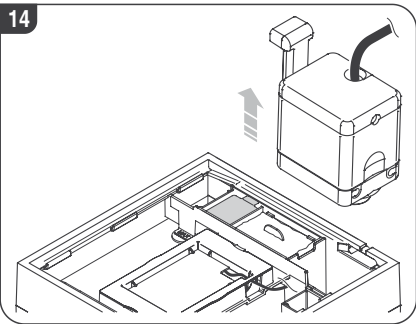
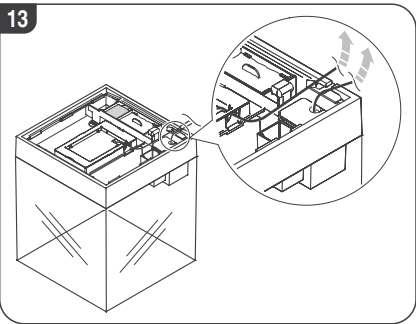

6.3.2. Pump replacement

- 1) After disconnecting the plug of each electric device, remove the cover and extract the cables from the fairlead seat and the cable guiding element (see fig. 13).
- 2) Extract the pump from the frame (see fig. 14) and replace it.
- 3) Dispose of the pump as specified under **chap. 10**.
- 4) Place the new pump, reassemble and reposition the components carefully repeating the above described procedure in opposite order.

6.4. Lighting unit replacement

- 1) After disconnecting the plug of each electric device, remove the cover and extract the cables from the fairlead seat and the cable guiding element (see fig. 13).
- 2) Extract the lighting unit using the grip points and replace it.
- 3) Dispose of the lighting unit in compliance with **chap. 10**.
- 4) Place the new lighting unit, reassemble and reposition the components carefully repeating the above descried procedure in opposite order.

7. TROUBLESHOOTING

ANOMALIES	CAUSES	SOLUTIONS
Lighting not working	Lack of connection of the plug to the power outlet	Connection the plug to the power outlet
	Lighting unit not working	Replace the lighting unit
	Other	Refer to a trustworthy retailer
No water flow rate	Lack of connection of the plug of the pump to the power outlet	Connection the plug to the power outlet
	Pump blocked	Clean the magnetic impeller (see par. 6.3.1)
	Other	Refer to a trustworthy retailer
Water flow rate insufficient	Inlet grids, pump, delivery tube clogged	Clean the parts

8. STORAGE AND PACKAGE

In case of product storage:

- 1) Clean and dry all parts making it up carefully. The mechanical filtration sponges, carbon and mix cartridges have to be disposed of in compliance with the regulations in force in the country where disposal takes place.
- 2) Store the product and its components in the original package box or in other suitable containers.
- 3) Keep indoor in a dry place, protected against weathering and temperature lower than 0°C.

9. SPARE PARTS

Component (see fig. 1, fig. 2, and fig. 3)		Codes
Pump PURE PUMP 170	Europe	AB350001
	UK	AB350002
Lighting unit LIGHT UNIT S	Europe	AB350006
	UK	AB350007
thermal heater and basket support KIT		AB350017
Cable guiding element (No. 2)	white	AB350021
	black	AB350022
	sand	AB350023
Cover	white	AB350025
	black	AB350026
	sand	AB350027
PURE FILTER MEDIA KIT S		AC350004
Magnetic impeller		AB350035
Pump shaft and extracting device		AB350036

10. PRODUCT DECOMMISSIONING

In compliance with 2002/95/EC, 2002/96/EC, and 2003/108/EC Directives, concerning the reduction in the use of hazardous substances in electric and electronic equipment, as well as waste disposal.

On the package and/or in the product, the symbol indicating the separate collection of electric and electronic equipment is printed in a visible, readable and indelible way. It consists of a crossed-out wheeled bin.

The user shall convey the discarded product to the collection centres in the own Municipality or return it to the retailer when purchasing a new equivalent product, on a one-against-one basis.

Suitable separate collection, which allows for the following recycling, treatment and compatible environmental disposal of the discarded product, contributes to prevent to affect negatively the environment and the health, besides easing reuse and/or recycling of the material of which the product is made. Abusive disposal of the product by the user implies the application of the administrative functions set forth by the regulations in force in the country of disposal.

Askoll

Askoll Due S.p.A.
Via Industria, 32/34 - 36031 DUEVILLE (VI) - ITALIA
www.askoll.com