

# Askoll

## PURE<sup>M</sup><sup>L</sup><sup>XL</sup> AQUARIUM KIT

Instruction manual

Manuale di istruzioni

Manuel d'instructions

Bedienungsanleitung

Manual de instrucciones

Handleiding

руководство по эксплуатации

EASY**AQUARIUM**





Congratulations!

By purchasing an Askoll PURE Aquarium you will not only enjoy a fully made-in-Italy design that harmonises well with several interior design styles, but you will also be able to rely on a product that concentrates the best of Askoll technology, a company that can boast more than thirty years experience in the design and production of articles for aquariums and ponds.

In just a few minutes, after starting installation, we are sure that you will appreciate a product conceived in every detail to make any operation easy and fast. You will enjoy even more the moment in which you will be able to dedicate your time to create a nature corner in your new Askoll PURE Aquarium and you will be able to count on cutting edge devices to preserve the beauty of the aquatic world along the time, in a simple way.

Before starting, kindly read and follow the warnings and hints contained in this manual carefully.

To choose fish, plants, and the arrangement suitable for your aquarium, follow the suggestions of an expert retailer.

To enhance inasmuch as possible the unique style of Askoll PURE aquarium, Askoll recommends using the aquarium stands specifically created for this product line.

NB. As reference, figures in the manual refer to the PURE L model.

## 1. IMPORTANT SAFETY INFORMATION

This product was designed and manufactured in compliance with the 2006/95/EC and 2004/108/EC Directives to assure a safe use along its entire life-cycle. However, an improper use of the product (not complying with the provisions of this manual) may cause damages to the product and jeopardise the user's safety.

### WARNING



Before using the product kindly read and understand this instruction manual in all its parts.  
This manual is an integral part of the product: keep it for future reference.

### WARNING



This product is not intended for use by persons (including children) with reduced physical, sensory and mental capabilities or lack of experience and knowledge, unless they have been given supervision or instruction concerning the use of the product by a person responsible for their safety. Children should be supervised to ensure that they do not play with the product.

#### To avoid electric risk:



Each power cable of the electric devices has to show a drip loop positioned lower than the plug-outlet connection point in order to prevent any drop from reaching such point.



The electric devices plug and outlet should not get wet.



Should the plug or outlet of any of the electric devices become wet, do not disconnect the cable. Disconnect power supply to the electric system acting on the main switch.



Disconnect the plugs of the electric devices from the outlets before handling the product and/or immersing the hands in water.



Never pull the cable of the electric devices to disconnect the plugs from the outlets. To disconnect them, grab the plugs and pull them.



The product has glass components.



Handle with care and place it according to the instructions of this manual avoiding to lean the tank directly on the edges.

**⚠ WARNING**

To avoid instability risk: check with a level that the support surface of the product is horizontal.



Do not lean the product on inclined surfaces.



After installation, do not move the product.  
If necessary, move it only if the tank is completely empty.



Do not connect the electric devices of the product to the mains before having completed the installation or having repositioned the same after maintenance operations. Do not use the thermal heater and the pump dry.



To avoid the risk of burns:  
After disconnecting the plug, let the hot parts of the thermal heater (about 30 minutes) and of the lighting unit (about 5 minutes) cool down, before handling them.



On the thermal heater, the warning light indicates only that the heating phase is active. When the warning light is off, it does not mean that the thermal heater is cool.



Check that the water level is always included in the min. and max. level range indicated on the column.



After maintenance operations, if necessary, restore the proper water level.

**⚠ CAUTION**

Use the product exclusively as decorative aquarium for indoor domestic use.



Each component is an integral part of the product.  
It shall not be used on other products.



Do not use the product for use with foodstuffs.



Do not use the product as terrarium.



Do not use the product, if damaged and/or disassembled.



Do not damage and/or remove the sealant positioned on the joints of the tank glasses (edge seals).



Do not lean any rocks, stones or other heavy decorating elements directly on the bottom of the tank.



Do not place any item on the product.



Verify the integrity of the product before pouring water into the tank.



The thermal heater must always be immersed at least up to the minimum level marked on the same.

## ⚠ CAUTION



Install the electric devices of the product observing the voltage and frequency values shown on the devices and the temperature ones specified among the technical data under **par. 3.4**.



Connect the electric devices to mains protected by a residual current device with a sensitivity  $\leq 30$  mA.



After maintenance operations, if necessary, dry the external parts of the product and the surface on which it is positioned.



To protect the polished surfaces of the product from scratches and scrapes, pay utmost care when cleaning and handling the same.



Do not cut the power cables.  
Power cables cannot be repaired.  
If the cable is damaged, the product has to be discarded.



Do not use extension cables.  
If the length of the power cable of the electric devices is not sufficient, refer to an electrician.



Do not try to repair any product component: in case of damage replace the damaged component with original spare parts (**see chap. 9**).



## 2. TABLE OF CONTENTS

1. IMPORTANT SAFETY INFORMATION.....	1
2. TABLE OF CONTENTS.....	3
3. PRODUCT SPECIFICATIONS.....	3
4. PREPARE PRODUCT FOR USE.....	6
5. OPERATION INSTRUCTIONS.....	9
6. MAINTENANCE AND CLEANING.....	12
7. TROUBLESHOOTING.....	15
8. STORAGE AND PACKAGE.....	16
9. SPARE PARTS.....	16
10. PRODUCT DECOMMISSIONING.....	16

## 3. PRODUCT SPECIFICATIONS

### 3.1. Product identification

Name Components	Askoll PURE Aquarium KIT			
	Model	PURE M	PURE L	PURE XL
Lighting unit	Model	LIGHT UNIT M	LIGHT UNIT L	LIGHT UNIT XL
	Type	D-52040	D-52060	D-52080
Thermal heater	Model	THERM L (100W)		
	Type	D-38100		
Pump	Model	PURE PUMP 300		
	Type	D-06004		

## 3.2. Component name and package content

Check that the package contains the components shown in the following figures.

### 1 Product, filter cover and lighting canopy

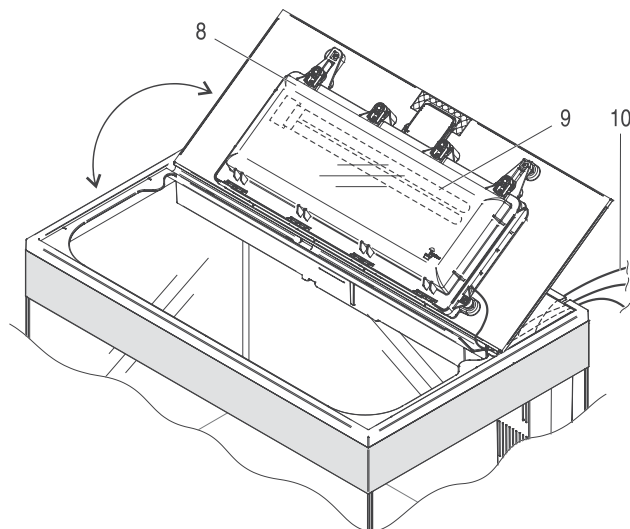
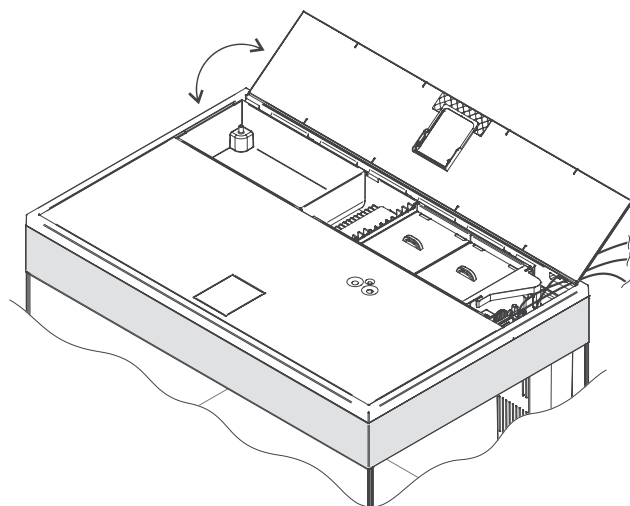
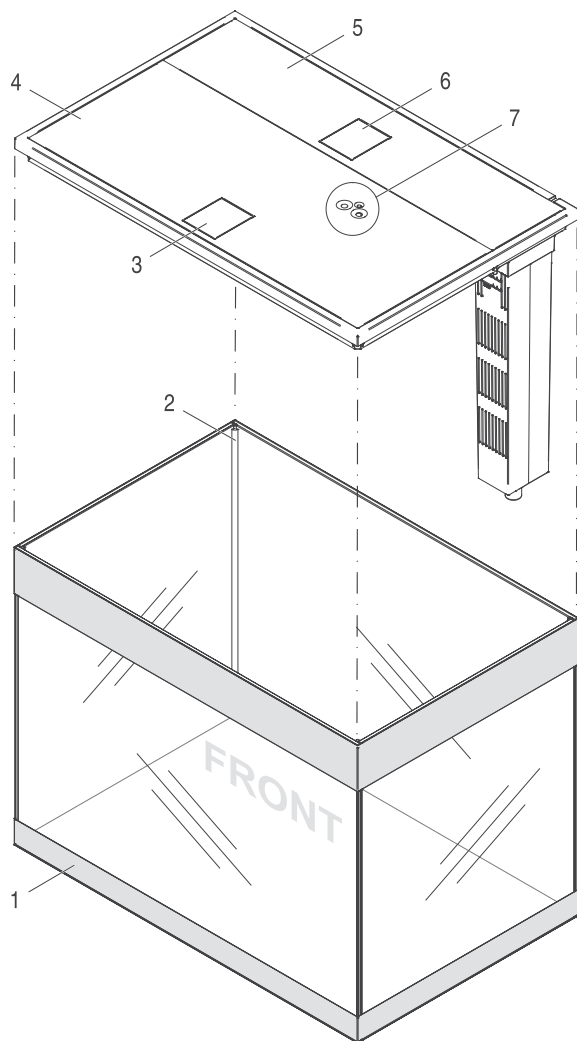

## 2 Detail: Frame, filters and electric devices

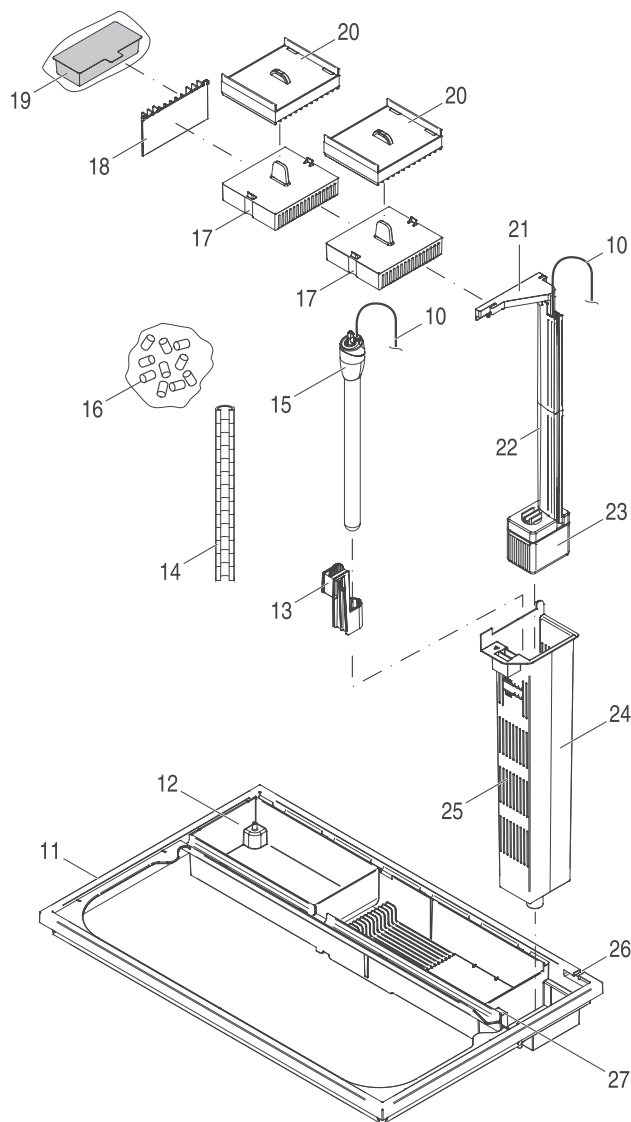

### Legend:

- 1) Tank
- 2) Edge seals (glass sealant)
- 3) Lighting canopy handle
- 4) Lighting canopy
- 5) Filter cover
- 6) Filter cover handle
- 7) Lighting timer buttons
- 8) Lighting unit
- 9) Lamp
- 10) Power cable with plug
- 11) Frame
- 12) Filter compartment
- 13) Thermal heater support
- 14) Cable guiding element
- 15) Thermal heater
- 16) Ceramic cylinders (bag)
- 17) Biological baskets for ceramic cylinders:  
Mod. PURE M = No. 1 basket  
Mod. PURE L = No. 2 baskets  
Mod. PURE XL = No. 3 baskets
- 18) Chemical filtration separator
- 19) Chemical cartridges (bag)  
Mod. PURE M and L = No. 1 carbon cartridge and No. 1 mix cartridge  
Mod. PURE XL = No. 2 carbon cartridges and No. 2 mix cartridges
- 20) Baskets for mechanical filtration sponges:  
Mod. PURE M = No. 1 basket  
Mod. PURE L = No. 2 baskets  
Mod. PURE XL = No. 3 baskets
- 21) Delivery (water outlet nozzle)
- 22) Delivery tube with cable protection
- 23) Pump
- 24) Column
- 25) Inlet grids
- 26) Fairlead seat
- 27) CO<sub>2</sub> tube connection

### 3.3. Optional modules

The product may be equipped with the following modules (not included).

Module	Description
ROBOFOOD programmable fish feeder	Battery-operated programmable fish feeder assuring up to two meals a day.
Askoll CO <sub>2</sub> System - CO <sub>2</sub> PRO-GREEN SYSTEM	It allows providing CO <sub>2</sub> to the aquarium thus easing plant growth.
Stand for PURE aquarium	Specifically designed, it is the best fitting for the aquarium, enhancing its style and providing a sturdy and suitable support to the same.

### 3.4. Technical data

Description		PURE M	PURE L	PURE XL
Capacity	<i>l</i>	44	68	94
	<i>Imp gal</i>	9.68	14.96	20.68
Product weight	<i>kg</i>	9.2	14.6	19.6
Max. weight with water	<i>kg</i>	70	105	150
Height	<i>cm</i>	43.5	43.5	43.5
Width	<i>cm</i>	36	56	76
Depth	<i>cm</i>	36	36	36
Water temperature (min./ max.)	°C	from +5 to +35		
PUMP / LIGHTING UNIT / THERMAL HEATER				
Power supply	<i>V / Hz</i>	See data provided on the individual electric devices making up the product.		
Consumption	<i>W</i>			
IP protection code				

## 4. PREPARE PRODUCT FOR USE

### 4.1. Unpacking

#### WARNING



The product has glass components. Handle with care and place it according to the instructions of this manual avoiding to lean the tank directly on the edges.



- 1) Open the package, remove the upper polystyrene corner elements and the protection film.
- 2) Extract the product handling it carefully.
- 3) Lean it on a flat, clean, and smooth surface avoiding to scratch and/or damage the glass tank bottom.
- 4) Open the lighting canopy (**see fig. 3**) and extract the carton contained in the tank.
- 5) Extract the column and the thermal heater from the carton.
- 6) Dispose of the packaging materials in compliance with the regulations in force in the country where disposal takes place.
- 7) Check that the product has all components shown in **par. 3.2**.

### 4.2. Positioning

Select the place where to install the product with care, observing the following provisions.

#### WARNING



To avoid instability risk: check with a level that the support surface of the product is horizontal. Do not lean the product on inclined surfaces.





## ⚠ CAUTION



It is advisable to place the product on the foreseen aquarium stand. Alternatively, use a sturdy support able to bear the maximum weight set for the product (see technical data). Such support must have a levelled, smooth and clean support surface.



In order not to ease algae proliferation: place the product far from heat sources and direct exposure to sunlight.

- 1) Place the product with the notice "FRONT" on the front side and at such a distance from the power outlet that it is possible to create a drip loop for each of the power cables of the electric devices.
- 2) Remove the label with the notice "FRONT" and dispose of the same in compliance with the regulations in force in the country where disposal takes place.

## 4.3. Assembly

### ⚠ CAUTION



To prevent the risk of scratching the product: clean it exclusively using a soft cloth moistened with water. Do not use abrasive products, toxic substances or detergents.

- 1) Lift the frame keeping the covers in their position (see fig. 4) and place it on a flat and clean surface, avoiding to scratch it.
- 2) Clean the tank with a cloth moistened with water (see fig. 5).
- 3) Prepare the tank bottom (sand or other suitable material) according to the arrangement desired.
- 4) Place the frame back on the tank.
- 5) Remove the lighting canopy from the frame and remove the adhesive tape holding the cable stuck to the lighting unit (see fig. 6).
- 6) Remove the filter cover from the frame (see fig. 7).
- 7) Remove the adhesive tape holding the thermal heater stuck to the column and extract it from the polystyrene ring (see fig. 8).

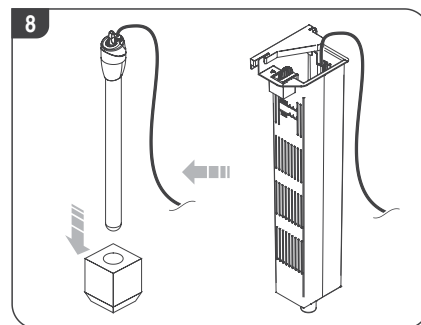
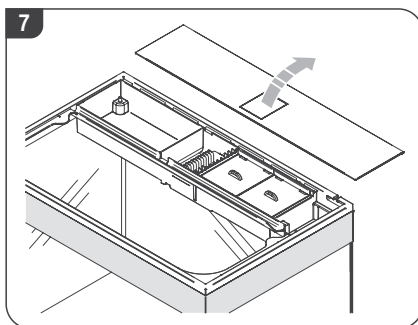
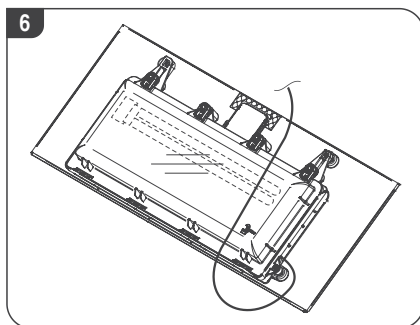
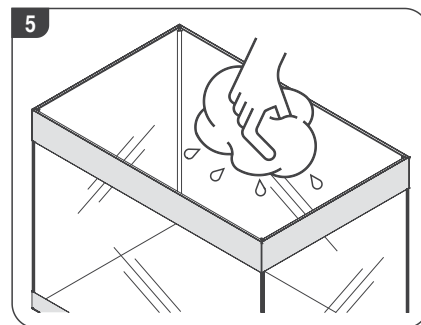
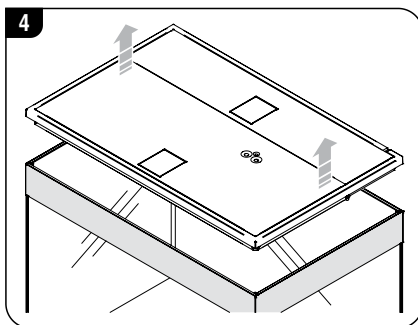
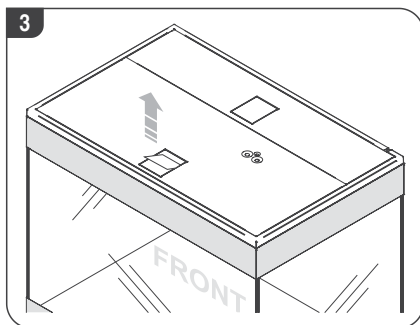

- 8) Insert the column in the frame and the thermal heater in the thermal heater support already fixed on the column **(see fig. 9)**.
- 9) Place the lighting canopy back on the frame and let the three power cables (lighting unit, pump and thermal heater) pass through the fairlead seat and then through the cable guiding element **(see fig. 10)**.
- 10) Extract the baskets for the mechanical filtration sponges and the biological baskets. Extract the sponges, rinse them under running water and place them back into the basket **(see fig. 11)**.
- 11) From the filter compartment extract the plastic bags containing the ceramic cylinders and the bag containing the carbon cartridge **(see fig. 12)** (No. 2 cartridges for mod. XL);
- 12) On a washbasin, open the bags, pour the ceramic cylinders in the baskets and rinse them under running water; rinse also the carbon cartridge **(see fig. 13)**.
- 13) Place the biological baskets, the baskets for the mechanical filtration sponges and the carbon cartridge back into their seats on the frame **(see fig. 14)**.
- 14) Place the filter cover back on the frame.

- 15) Dispose of the plastic bags in compliance with the regulations in force in the country where disposal takes place.

#### 4.4. Installation

##### ⚠ WARNING



Do not connect the electric devices of the product to the mains before having completed the installation.  
Do not use the thermal heater and the pump dry.



After installation, do not move the product.  
If necessary, move it only if the tank is completely empty.

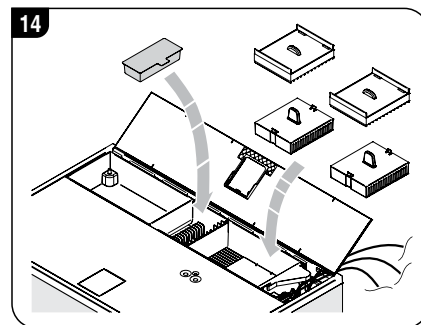
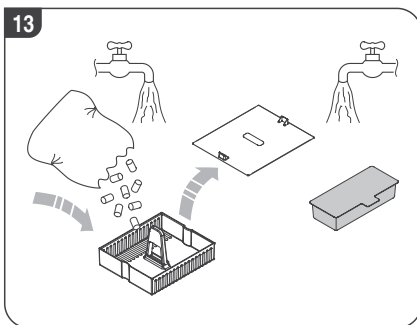
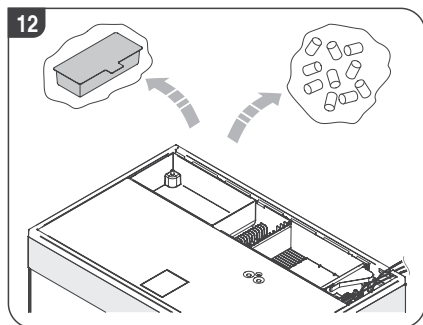
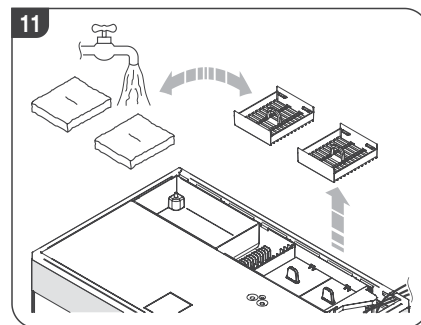
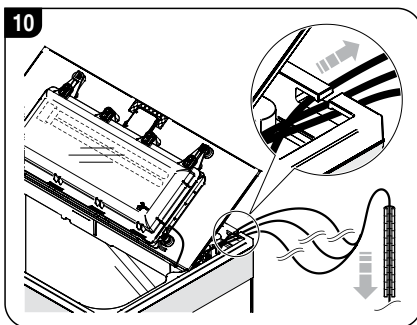
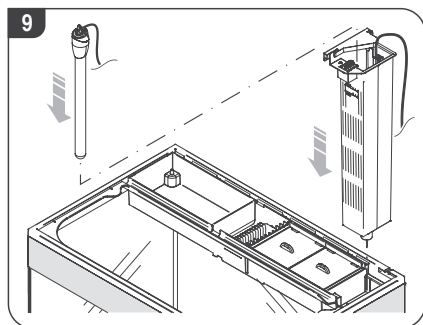

## ⚠ CAUTION



Do not lean any heavy item on the column.



Prevent the bottom (sand or other material), algae or any other items present in the tank from obstructing the inlet grids of the column.

- 1) Open the lighting canopy and slowly fill the tank with about 1/3 water; then, place any decorations or aquatic plants.
- 2) Slowly fill the tank up to a level included within the min. and max. level range marked on the column **(see fig. 15)**.
- 3) Close the lighting canopy and verify that there are no leaks.
- 4) Open the filter cover and set the thermal heater to the desired temperature using the adjustment knob of the graduated scale **(see fig. 16)**.
- 5) Close the filter cover.

## 5. OPERATION INSTRUCTIONS

### 5.1. Routine operation

## ⚠ WARNING



To avoid electric risk:  
Each power cable of the electric devices has to show a drip loop positioned lower than the plug-outlet connection point in order to prevent any drop from reaching such point.

- 1) Read the warnings under **chap. 1**.
- 2) After having connected the plug of each electric device verify the operation of the same (in case of malfunction refer to **chap. 7**):
  - Water has to exit from delivery output.
  - The warning light of the thermal heater has to turn on, if water temperature is lower than the set one.
  - By pressing “ON/OFF” on the lighting timer, the lamp has to turn on (press “ON/OFF” once again to turn it off) **(see fig. 17)**.
- 3) Wait until water temperature reaches the value set on the thermal heater. Check the temperature with a suitable thermometer (not supplied).
- 4) Add the fish, if wished, according to your own experience and following the rules relating to aquariology good practices.

### 5.1.1. Filtration

## ⚠ CAUTION



Always close the filter cover, after having performed the necessary operations in order to avoid promoting algae proliferation in the filters due to the presence of light.

In order to provide for the best habitat for fish and plants, the water of each aquarium has to continuously undergo mechanical, biological and chemical filtration.

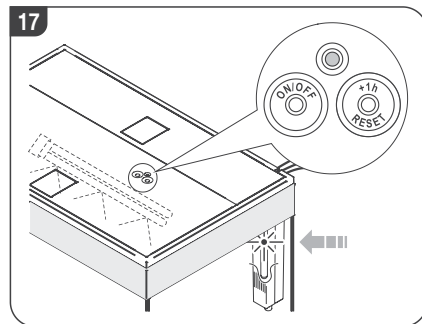
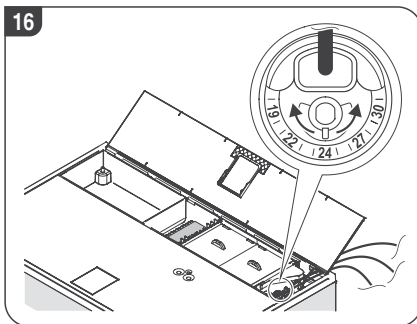
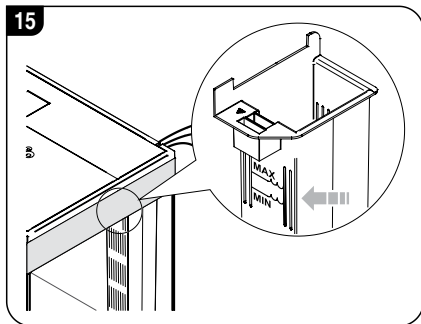

The **mechanical filtration** (see fig. 18), carried out by the mechanical filtration sponges made of polyurethane, eliminates any suspended particles making water clear. It is always possible to visually check the clogging level of the sponges simply by opening the filter cover.

The **biological filtration** (see fig. 19), carried out by the nitrifying bacteria nesting in the pores of the ceramic cylinders, aims at keeping aquarium water free from chemicals, which are harmful for the aquatic fauna, transforming the ammonia produced by the fish into nitrates. In order to allow a sufficient quantity of bacteria to settle down in the filtration media and carry out such water purification function, about 4 weeks are necessary. Therefore, the first month of an aquarium is rather critical and the fish has to be added very gradually in order to allow the nitrifying bacteria to settle down, reproduce and be effective.

Finally, the **chemical filtration** (see fig. 20) is carried out by the active carbon contained in the carbon cartridge or by the mix of resins contained in the mix cartridge. Thanks to the very high carbon porosity, potentially noxious chemical compounds, pharmaceutical residues, smells, waste substances, which reduce water clarity, etc. are removed.

The mix cartridge allows removing efficiently nitrates and phosphates, freeing water from the main cause of algae proliferation.

The regular and alternated use of the carbon and mix cartridges (see par. 6.2) allows keeping under control the water pollution degree, efficiently preventing algae development and keeping water clear and crystalline.

### REMARK

In saltwater aquariums the mix cartridges function is limited to the removal of phosphates, while it is ineffective against nitrates.

## 5.1.2. Lighting

The lighting unit recreates natural lighting and enhances the colours of the aquatic fauna and flora. If programmed, it switches on and off automatically at the set time every day.

- To program it, proceed as follows:

- 1) Press (the lamp turns on) and keep pressed the "ON/OFF" button until the LED lights (blue colour). Always keeping the "ON/OFF" button pressed, press the "+1h / Reset" button so many times as are the hours that need to elapse from the current time to the time you wish to turn on the lamp every day (**Example: if it is 08:00 a.m. and you wish the aquarium to turn on at 10:00 a.m. press the "+1h / Reset" button twice**).
- 2) Release the "ON/OFF" key: the LED confirms the occurred switching on time programming by flashing.
- 3) Press (the lamp turns off) and keep the "ON/OFF" button pressed until the LED turns on. Always keeping the "ON/OFF" button pressed, press the "+1h / Reset" button so many times as are the light hours you wish to have starting from switching on (**Example: if you wish the aquarium to switch off at 6:00 p.m. of every day, and switching on is programmed to occur at 10:00 a.m., press the "+1h / Reset" button 8 times**).
- 4) Release the "ON/OFF" key: the LED confirms the occurred switching off time programming by flashing.

- To verify the occurred programming, press the "ON/OFF" button (the lamp turns on): if the programming has been successfully performed, the LED flashes. Turn off the lamp by pressing the "ON/OFF" button once again.

- To cancel programming, keep the "+1h / Reset" key pressed until the LED turns off.

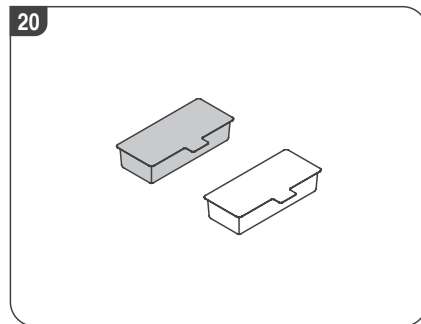
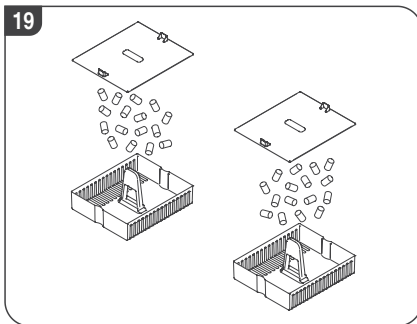
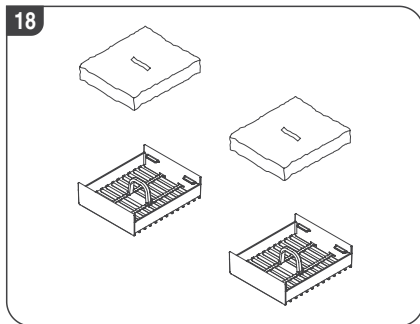



In any case, also when programming is enabled, the lighting unit can be turned on and off by pressing the "ON/OFF" button of the lighting timer.

 **CAUTION**

The "ON/OFF" button of the lighting timer does not perform any switch function and does not disconnect the lighting unit from the mains.

5.1.3. Heating

 **WARNING**



To avoid the risk of burns:  
After disconnecting the plug, let the hot parts of the thermal heater (about 30 minutes) and of the lighting unit (about 5 minutes) cool down, before handling them.  
On the thermal heater, the warning light indicates only that the heating phase is active. When the warning light is off, it does not mean that the thermal heater is cool.

 **CAUTION**



The thermal heater is factory calibrated. Variables like low ambient temperature, large temperature fluctuations, lack of covers, positioning of the product close to cooling sources, may require a higher power to provide for a better temperature control.

The thermal heater allows adjusting aquarium temperature (from 18°C to 31°C) using the adjustment knob of the graduated scale.  
After commissioning the equipment for the first time and reaching the set water temperature, the thermal heater keeps water temperature constant by suitable on-off cycles.

**REMARK**

The thermal heater assures the set water temperature regulation only when the set temperature is higher than ambient temperature.

5.2. In case of power failure

- Power failure (blackout) may result in:
- The progressive reduction, after some hours, of the effectiveness of the biological filter with possible following damages to the aquarium ecosystem.
  - The shifting of the on/off time of the lamp by a time span equal to blackout duration (**Example: if the lighting unit is programmed to turn on the lamp at 10:00 a.m. and turn it off at 6:00 p.m., a blackout lasting one hour will shift switching on at 11:00 a.m. and switching off at 7:00 p.m. till new programming).**
  - A possible lowering of water temperature proportional to the blackout duration.

In case of malfunction refer to **chap. 7**.

6. MAINTENANCE AND CLEANING

**WARNING**

To avoid electric risk:



Disconnect the plugs of the electric devices from the outlets before handling the product and/or immersing the hands in water.



Never pull the cable of the electric devices to disconnect the plugs from the outlets. To disconnect them, grab the plugs and pull them.



Do not connect the electric devices of the product to the mains before having completed the installation or having repositioned the same after maintenance operations. Do not use the thermal heater and the pump dry.



To avoid the risk of burns:

After disconnecting the plug, let the hot parts of the thermal heater (about 30 minutes) and of the lighting unit (about 5 minutes) cool down, before handling them.



On the thermal heater, the warning light indicates only that the heating phase is active. When the warning light is off, it does not mean that the thermal heater is cool.



Check that the water level is always included in the min. and max. level range indicated on the column.



After maintenance operations, if necessary, restore the proper water level.

**CAUTION**



Always close the filter cover, after having performed the necessary operations in order to avoid promoting algae proliferation in the filters due to the presence of light.



In case of saltwater aquariums, perform a frequent and careful cleaning (at least once a month) of the parts affected by saline condensate.

6.1. Maintenance and cleaning interventions

Observe the forecast intervention schedule in order to preserve maximum effectiveness of the product.

Frequency	Intervention point	Intervention description
Every week	Filters	Visual check
	Tank	Water level check
See RFS (par. 6.2)	Filters	Replacement
Every 6 months	Pump	Cleaning

6.2. Rolling Filtration System

In order to assure maximum efficiency of the filters at any time , as well as the best water conditions in the aquarium, Askoll recommends to replace the filtration media regularly, in compliance with the Rolling Filtration System (RFS).

This can be attained very easily by purchasing the original spare parts Kit by Askoll, which includes everything needed.

To replace the sponges and cartridges, proceed as follows:

- 1) Open the filter cover.
- 2) Remove the sponges and the cartridges and dispose the same in full compliance with the regulations in force in the country where product disposal takes place.
- 3) Replace the sponges and cartridges as established in the table.
- 4) Close the filter cover.

The PURE FILTER MEDIA KIT spare parts kit for Askoll PURE M / L / XL aquariums can be purchased from your trustworthy retailer (see product code under **chap. 9**) and contains the following filtration media:









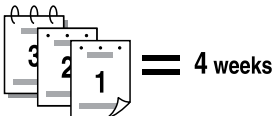
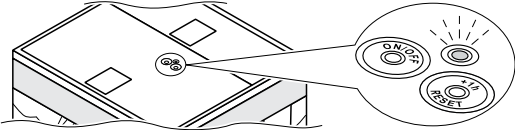

- 1 sponge for mechanical filtration
- 1 active carbon cartridge for chemical filtration
- 1 mix cartridge (anti-nitrates and anti-phosphates) for chemical filtration

In order to keep excellent aquarium conditions, Askoll suggest purchasing a package of PURE FILTER MEDIA KIT each month for PURE M and PURE L aquariums; while for the PURE XL aquarium, two packages a month are forecast.

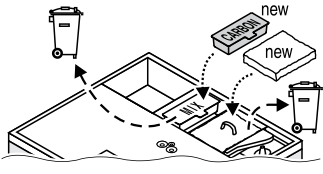
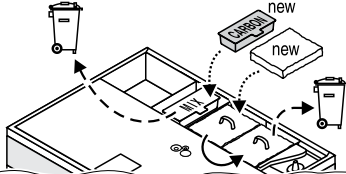
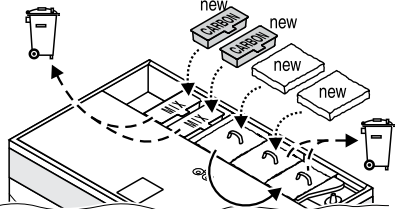
The scheme on the side outlines the replacement sequence for the individual filtration media, which involves the replacement of the sponge for mechanical filtration once a month and the alternation of the carbon cartridge with the mix cartridge every 2 weeks.

The same intervals are valid for the PURE XL aquarium, only in this case, the cartridges and sponges are replaced 2 at a time.

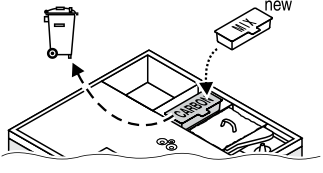
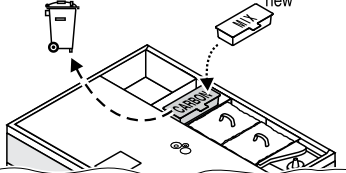
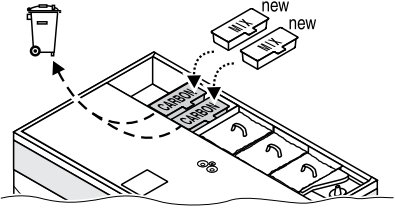
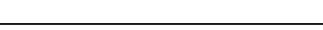
12

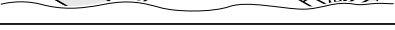
MONTHLY MAINTENANCE CYCLE (RFS - Rolling Filtration System)				
		PURE M (44 L)	PURE L (68 L)	PURE XL (94 L)
Blinking signal		 		
Monthly maintenance kit		 No. 1 sponge No. 1 mix cartridge No. 1 carbon cartridge	 No. 1 sponge No. 1 mix cartridge No. 1 carbon cartridge	 = No. 2 sponges No. 2 mix cartridges No. 2 carbon cartridges
REPLACEMENT CYCLE	1 <sup>st</sup> week			
	2 <sup>nd</sup> week			
	3 <sup>rd</sup> week			
	4 <sup>th</sup> week			
ARROW LEGEND:    .....➔ element to be inserted    - - ➔ element to be discarded    ➔ element to be shifted				

Operation	<p>When the “media timer” is enabled, the LED blinks periodically (4 weeks) warning about the scheduled maintenance to be done. Every 4 weeks, the LED blinks until the reset procedure is carried out.</p> <p>To reset the signalling, press the reset key for about 1 second: the LED stops blinking.</p>
Function enabling	<p>Press the two buttons and keep them pressed for about 3 seconds: the enabling is signalled by an intermittent switching-on of the LED with increasing frequency. Release the buttons</p>
Function disabling	<p>Press the two buttons and keep them pressed for about 3 seconds: the disabling is signalled by an intermittent switching-on of the LED with decreasing frequency. Release the buttons.</p>
Verify the programming status	<p>To verify the media timer programming status, press the reset button and keep it pressed for about 1 second (but less than 5 seconds in order to avoid resetting any lighting timer programming).</p> <p>The active status is signalled by an intermittent switching-on of the LED with increasing frequency.</p> <p>The deactivated status is signalled by an intermittent switching-on of the LED with decreasing frequency.</p>



### 6.3. Column and pump maintenance

#### ⚠ CAUTION



Pump power cable has to be positioned always inside the cable protection of the delivery tube.

#### 6.3.1. Cleaning and pump replacement, if necessary

- 1) After disconnecting the plug of each electric device, remove the filter cover and extract the cables of the electric devices from the fairlead seat and the cable guiding element.
- 2) Wait for the hot parts of the thermal heater (about 30 minutes) to cool down, before extracting it carefully: extract also the support from the column (**see fig. 21**).
- 3) By disconnecting the delivery from the column, extract the assembly consisting of delivery (water outlet nozzle), delivery tube and pump (**see fig. 22**).
- 4) Disconnect the pump from the delivery tube and extract the power

cable from the cable protection of the delivery tube (**see fig. 23**).

- 5) If necessary, replace the pump (and dispose of it in compliance with the provisions given under **chap. 10**); otherwise, proceed as per following point.
- 6) Separate the upper cover from the pump body and extract the magnetic impeller (**see fig. 24**); rinse it under running water (**see fig. 25**).
- 7) Clean the seat of the magnetic impeller with a non abrasive brush (**see fig. 25**).
- 8) Reassemble and place the pump and the other components back to their position, repeating the above described procedure in opposite order.

#### 6.3.2. Column replacement

- 1) After disconnecting the plug of each electric device, remove the filter cover and the lighting canopy.
- 2) Extract the cables of the electric device from the fairlead seat and the cable guiding element.
- 3) Wait for the hot parts of the thermal heater (about 30 minutes) to cool

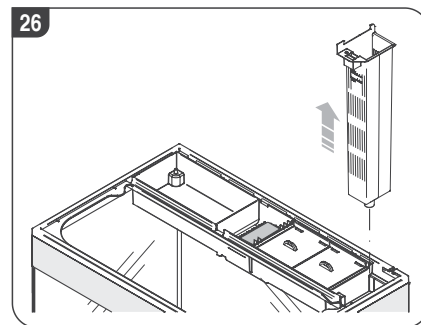
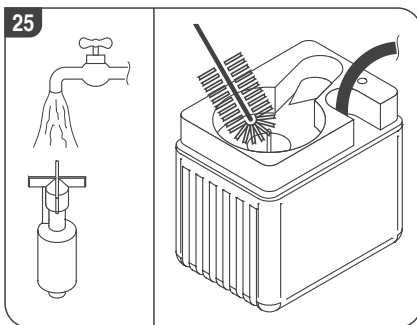
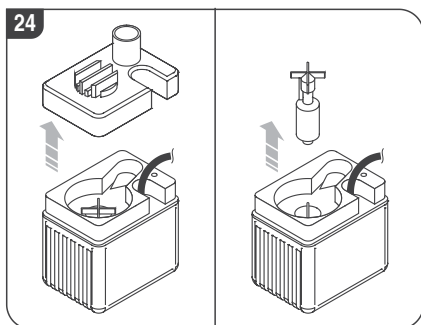
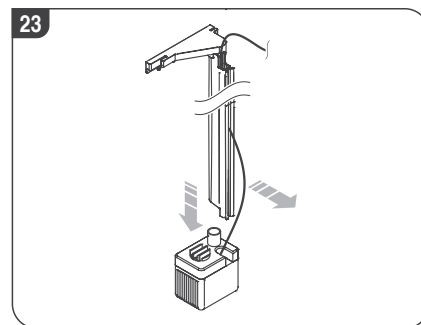
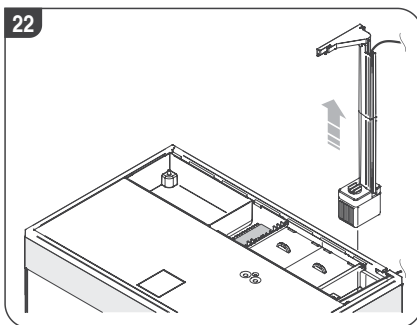
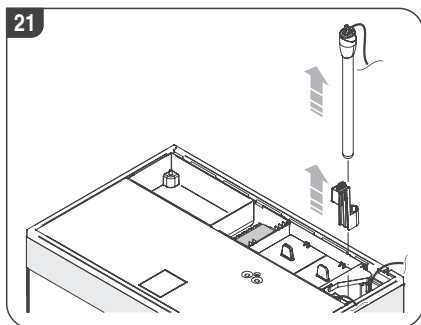



- down, before removing it carefully.
- 4) Extract the thermal heater support from the column (**see fig. 21**).
  - 5) By disconnecting it from the column delivery, extract the assembly consisting of delivery (water outlet nozzle), delivery tube and pump (**see fig. 22**).
  - 6) Extract and replace the column (**see fig. 26**).
  - 7) Place the new column, reassemble and reposition the components carefully repeating the above described procedure in opposite order.
  - 8) Dispose of the column in compliance with the regulations in force in the country where disposal takes place.

## 6.4. Lamp replacement

- 1) After disconnecting the plug of the lighting unit, remove the filter cover and the lighting canopy.
- 2) Lean the cover and canopy on a surface protected with a cloth in order not to scratch them.

### ⚠ WARNING



Dry the lighting unit before starting the lamp replacement procedure.

- 3) Using a flat screwdriver (width from 5.5 to 6 mm), rotate the fastening devices by 90° (**see fig. 27**).
- 4) Remove the light fixture (**see fig. 28**) and lean it on a surface protected by a cloth.
- 5) With dry hands, release the lamp from the connection, extract it from the seat (**see fig. 29**) and replace it.
- 6) Reassemble and reposition the components carefully repeating the above described procedure in opposite order.
- 7) Dispose of the lamp as specified under **chap. 10**.

27

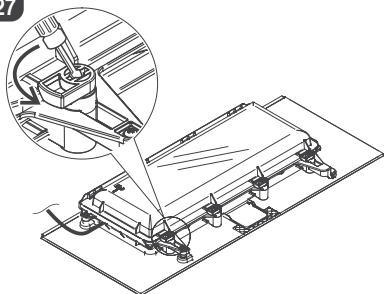

28

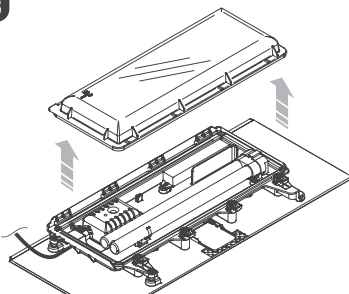

29

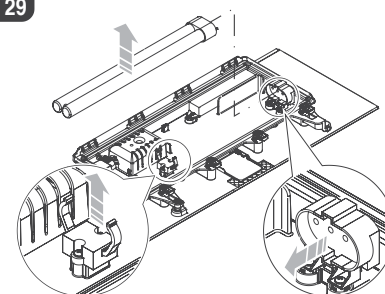

## 7. TROUBLESHOOTING

ANOMALIES	CAUSES	SOLUTIONS
Lighting not working	Missing connection of the plug to the power outlet	Connect the plug to the power outlet
	Faulty lamp	Replace the lamp ( <b>see par. 6.4</b> )
	Other	Refer to a trustworthy retailer
Water temperature low	Missing connection of the plug of the thermal heater to the power outlet	Connect the plug to the power outlet
	Thermal heater adjustment knob set on a too low value	Adjust the temperature to the right value ( <b>see par. 5.1.3</b> )
	Ambient temperature too low	Add an additional thermal heater
	Other	Refer to a trustworthy retailer
No water flow rate	Missing connection of the plug of the pump to the power outlet	Connect the plug to the power outlet
	Pump blocked	Clean the magnetic impeller ( <b>see par. 6.3.1</b> )
	Other	Refer to a trustworthy retailer
Water flow rate insufficient	Inlet grids, pump, delivery tube or delivery clogged	Clean the parts

8. STORAGE AND PACKAGE

In case of product storage:

- 1) Clean and dry all parts making it up carefully. The mechanical filtration sponges, carbon and mix cartridges have to be disposed of in compliance with the regulations in force in the country where disposal takes place.
- 2) Store the product and its components in the original package box or in other suitable containers.
- 3) Keep indoor in a dry place, protected against weathering and temperature lower than 0°C.

9. SPARE PARTS

Model		PURE M	PURE L	PURE XL
Component		Codes		
Pump PURE PUMP 300	Europe	AB350003		
	UK	AB350004		
Lighting unit (excluding lamp) LIGHT UNIT	Europe	AB350008	AB350010	AB350012
	UK	AB350009	AB350011	AB350013
Thermal heater THERM L (100W)	Europe	AA230003		
	UK	AA230008		
Light fixture		AB350014	AB350015	AB350016
Column with thermal heater support		AB350019		
Delivery and delivery tube with cable protection KIT		AB350020		
Baskets KIT (No. 1 biological basket for ceramic cylinders, No. 1 basket for mechanical filtration sponges, No. 1 chemical filtration separator)		AB350018		
Cable guiding element (No. 2)	white	AB350021		
	black	AB350022		
	burgundy	AB350024		
Lighting canopy and filter cover	white	AB350028	AB350031	AB350033
	black	AB350029	AB350032	AB350034
	burgundy	AB350030	AB350037	AB350038
PURE FILTER MEDIA KIT M, L, XL		AC350005		
Askoll PURE MAX MINI ceramic cylinders 100g		AC350006		

Model	PURE M	PURE L	PURE XL
Component	Codes		
Lamp PURE LIGHT M (18W)	AC350001	/	/
Lamp PURE LIGHT L (24W)	/	AC350002	/
Lamp PURE LIGHT XL (36W)	/	/	AC350003
Magnetic impeller	AB350005		

10. PRODUCT DECOMMISSIONING

In compliance with 2002/95/EC, 2002/96/EC, and 2003/108/EC Directives, concerning the reduction in the use of hazardous substances in electric and electronic equipment, as well as waste disposal.

On the package and/or in the product, the symbol indicating the separate collection of electric and electronic equipment is printed in a visible, readable and indelible way. It consists of a crossed-out wheeled bin.

The user shall convey the discarded product to the collection centres in his own Municipality or return it to the retailer when purchasing a new equivalent product, on a one-against-one basis.

Suitable separate collection, which allows for the following recycling, treatment and compatible environmental disposal of the discarded product, contributes to prevent to affect negatively the environment and the health, besides easing reuse and/or recycling of the material of which the product is made. Abusive disposal of the product by the user implies the application of the administrative functions set forth by the regulations in force in the country of disposal.

# Askoll

Askoll Due S.p.A.  
Via Industria, 32/34 - 36031 DUEVILLE (VI) - ITALIA  
[www.askoll.com](http://www.askoll.com)